

FLOOR ATLANTIC . CONGRESS CENTRE



Audio Visual Equipment Integrated in the Conference Rooms (against payment)
Built-in voice and audio sound system in all conference rooms

Microphones:

- 8 wireless handheld microphones
- 4 wireless headset microphones
- 4 wireless clip microphones

Screens:

- 9 built-in screens 4 m x 3 m
- 1 portable screen 4 m x 3 m

LCD Projectors:

- 10 LCD Projectors (4500 lumens)
- Flip charts
- Laser pointers
- Remote control for curtains

Support Infrastructures Services Available:

- WI-FI in public areas and meeting rooms
- Reception facilities for groups
- Direct access for coaches
- Digital signposting to guide delegates.
- Exclusive area for secretarial services
- Valet Parking

	Area	Dimensions	Height	Capacity					
				Theatre	Classroom	Cabaret	U shape	Cocktail	Banquet
ATLANTIC + Foyer	1029 m2	10,7 m x 25,65 m 25 m x 30,2 m	4,2 m	1.028	588	366	102	980	610
ATLANTIC I + II + III	755 m2	25 m x 30,2 m	4,2 m	864	510	288	90	720	480
ATLANTIC I	247 m2	25 m x 9,9 m	4,2 m	187	144	84	69	235	200
ATLANTIC II	263 m2	25 m x 10,5 m	4,2 m	221	144	84	69	250	200
ATLANTIC III	245 m2	25 m x 9,8 m	4,2 m	187	144	84	69	235	200
Foyer ATLANTIC*	346 m2	10,7 m x 25,65 m 4,7 m x 15,25 m	4,2 m	-	-	-	-	330	-

* If using any room, except ATLANTIC + Foyer

On the Theater / Classroom / Cabaret set up's, minimum areas for top table, lectern and frontal projection have been already considered.

FLOOR PACIFIC . CONGRESS CENTRE

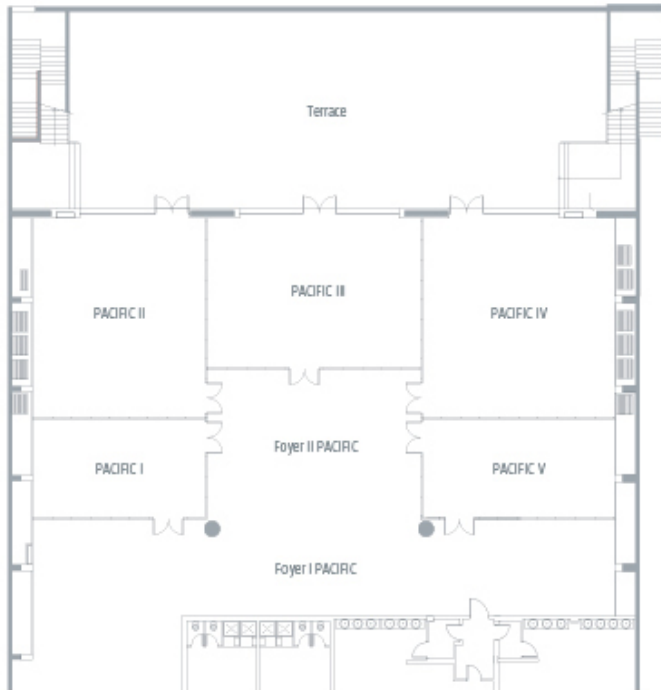

Audio Visual Equipment Integrated in the Conference Rooms (against payment)
Built-in voice and audio sound system in all conference rooms

Microphones:

- 8 wireless handheld microphones
- 4 wireless headset microphones
- 4 wireless clip microphones

Screens:

- 9 built-in screens 4 m x 3 m
- 1 portable screen 4 m x 3 m

LCD Projectors:

- 10 LCD Projectors (4500 lumens)
- Flip charts
- Laser pointers
- Remote control for curtains

Support Infrastructures Services Available:

- WI-FI in public areas and meeting rooms
- Reception facilities for groups
- Direct access for coaches
- Digital signposting to guide delegates.
- Exclusive area for secretarial services
- Valet Parking

	Area	Dimensions	Height	Capacity					
				Theatre	Classroom	Cabaret	U Shape	Cocktail	Banquet
PACIFIC + Foyers I & II	819 m2	23,4 m x 35 m	4,2 m	693	537	288	96	780	480
PACIFIC I + II + III + IV + V + Foyer II Pacific	619,5 m2	17,74 m x 35 m	4,2 m	643	459	234	96	600	390
PACIFIC I	62 m2	5,8 m x 10,7 m	4,2 m	56	36	24	30	60	40
PACIFIC II	126 m2	11,75 m x 10,7 m	4,2 m	98	72	54	33	120	90
PACIFIC III	114,5 m2	8,85 m x 12,9 m	4,2 m	96	60	48	36	110	80
PACIFIC IV	132 m2	11,75 m x 11,25 m	4,2 m	98	72	54	33	125	90
PACIFIC V	66 m2	5,9 m x 11,25 m	4,2 m	56	36	25	30	65	40
Foyer I PACIFIC	199,5 m2	5,7 m x 35 m	4,2 m	-	-	-	-	190	-
Foyer II PACIFIC	114 m2	8,8 m x 12,95 m	4,2 m	-	-	-	-	110	-
Terrace PACIFIC	360 m2	-	4,2 m					345	

On the Theater / Classroom / Cabaret set up's, minimum areas for top table, lectern and frontal projection have been already considered.